



Project: **Jindera Multi-Purpose Hall**

April 2019



Council is proposing to develop the Jindera Multi-Purpose Hall providing a venue for indoor sports and catering for community functions of various sizes.

The project will provide a sporting facility, function room and disabled access throughout the entire building.

It is proposed that the new hall will be built upon land at the Jindera Recreation Reserve and it will utilise new parking and access ways that are to be provided adjacent to Urana Street.

The proposed Jindera Multi-Purpose Hall has been designed by EDM Group.

The design process involved members of the community including the current

Jindera Sports Stadium Committee meeting with Council's staff and the designers.

The proposed building has been assessed by a Quantity Surveyor to cost \$3,394,276 ex GST which represents a significant investment for Greater Hume Council.

Council estimates additional expenditure of \$350,000 for car parking, landscaping and the installation of solar panels to the building, making a total project estimate of \$3,744,276 excluding GST.

Consequently the timing for commencement will be dependent on Council obtaining grant funding for the project.

It is anticipated that grant funding could be sourced from Federal and State Governments, community contributions, sales of Council assets and development contributions.

KEY FACTS:

- Cost estimate for the project requires an investment of \$3,744,276 excluding GST
- Possible funding sources include Federal and NSW State Government grants, sale of Council owned assets, development contributions and community fund raising activities
- Timing of the project is subject to funding being obtained
- The project has been designed to meet the needs of persons with disability, and ensure disabled access throughout the building and precinct

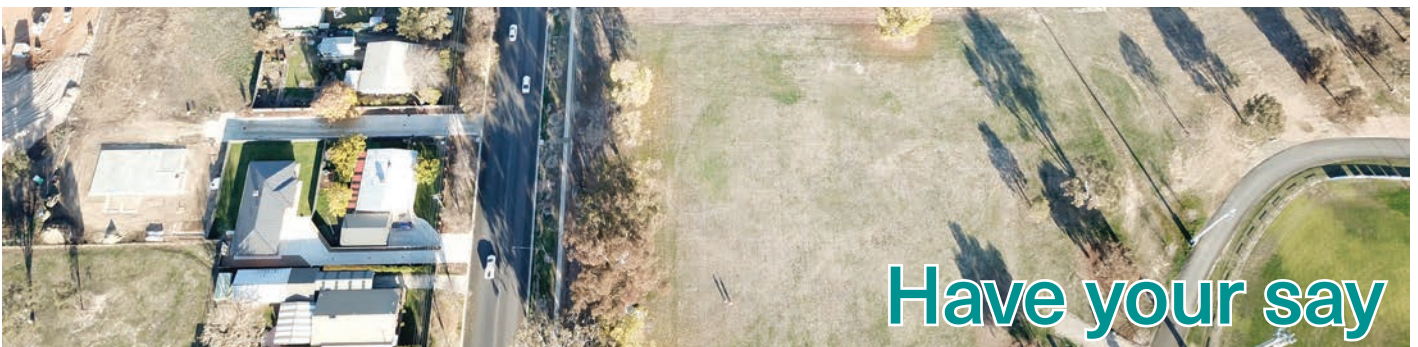

Have your say

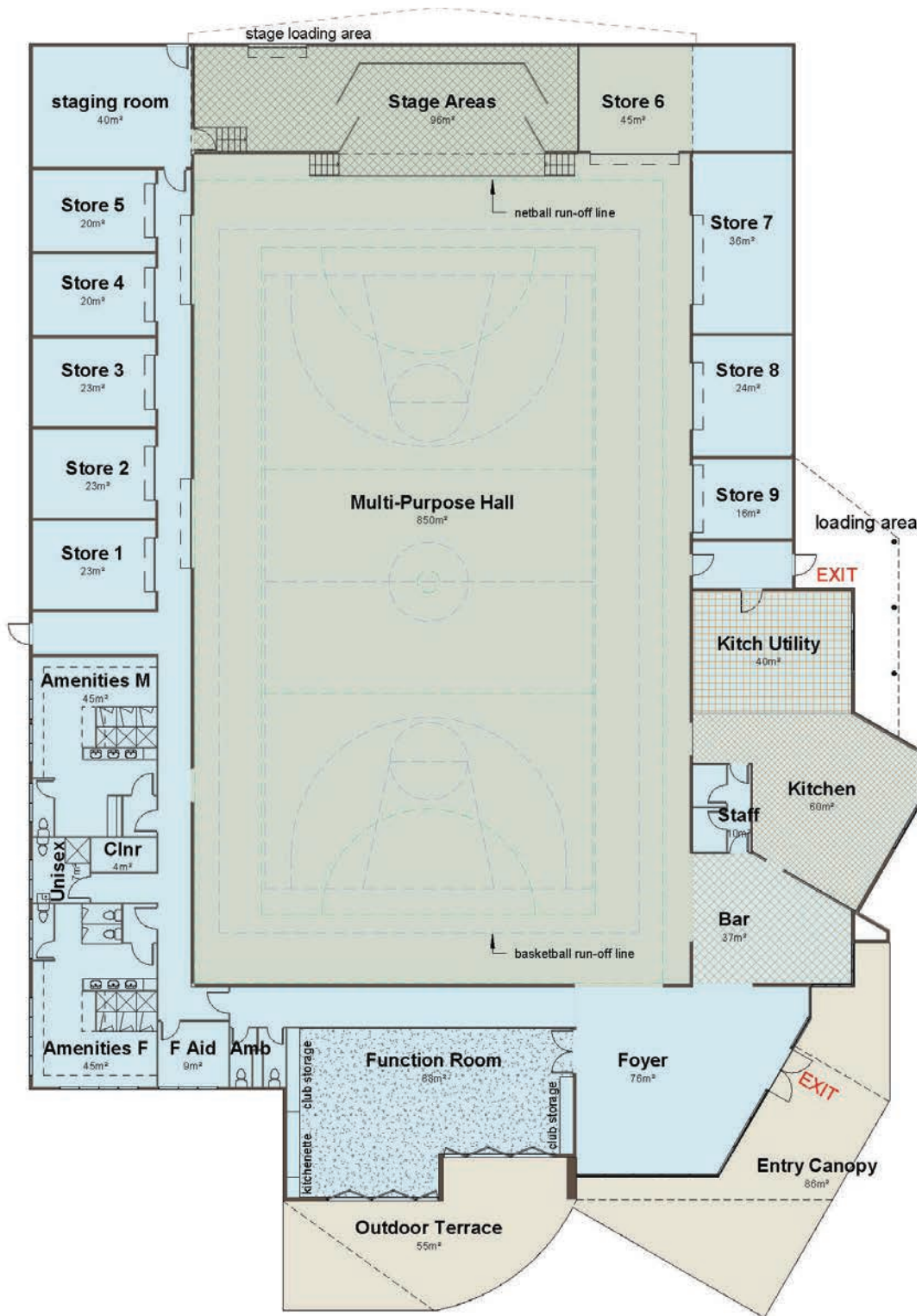

Benefits of the project:

- It replaces the existing Jindera School of Arts Hall
- An accessible building for the entire community
- A building designed to minimise maintenance and utility costs
- A building able to be used for many purposes

Negative implications of the project:

- Negative sentiment arising from the demolition of the ageing School of Arts Hall which is heritage listed
- An expenditure increase in Council's Operational Budget due to inclusion of a substantial new asset
- Funds committed to the Jindera Multi-Purpose Hall could be directed to alternate Council projects



Above:

An aerial view of the proposed redevelopment of the Jindera Recreation Reserve.

The map also shows the location of the proposed new adventure playground and car parking to be established in the precinct to ensure safe access to the new facilities off Urana Road.

Construction of the skate park commences shortly.

Jindera Multi-Purpose Hall

Adventure Playground

See the plans on display at the Jindera Community Hub 1 May - 1 July 2019

Jindera Community Hub is open Monday to Friday 8.30am to 5.00pm (closed from 1.00pm to 1.45pm)

Have your say about the projects

Community Feedback and Suggestions

Council values feedback and suggestions from the community on major projects such as the Jindera Multi-Purpose Hall.

Council would particularly like to know:

- Does the Council need to replace the existing Jindera School of Arts Hall with the Jindera Multi-Purpose Hall?
- Will the Jindera Multi-Purpose Hall cater for the

requirements of the Jindera Community?

- Is the cost of the Jindera Multi-Purpose Hall acceptable?
- Should Council be undertaking alternate projects instead of developing the Jindera Multi-Purpose Hall?
- Are you happy for the School of Arts Hall to be demolished on completion of the Jindera Multi-Purpose Hall?

Council requires your feedback and suggestions by 1 July 2019 so that further consideration of this project can occur.

You can provide your suggestions and feedback by -

- **Visit the static display** at Jindera Community Hub, 83 Urana Street, Jindera and fill out the feedback form
- **View the plans** on Council's website and provide your comments via the [Have Your Say page](#)
- **Write** to Council - PO Box 99, HOLBROOK NSW 2644

Should you require further assistance or information

contact

Colin Kane

Director Environment & Planning

E ckane@greaterhume.nsw.gov.au

P (02) 6036 0100

during normal office hours.

