

THE JINDERERA NEWS

FREE local Newsletter distributed by the first Saturday of each month (except January) published by:-



A Jindera based, not-for-profit charity organisation.

AUSKICK IS THRIVING IN JINDERERA!

The noise of happy, active kids can again be heard coming from Jindera's Footy oval every Friday evening. Auskick is up and running again this year and the kids are loving it.



Auskick is a fun program for kids for 5 to 12 year old's. During weekly sessions, our kids not only practice footy skills but learn about cooperation, team work and gain self-confidence. It's not just the kids who get to participate. The parents and carers who are volunteering each week are benefiting from being actively involved.

Last year, Jindera Auskick, was recognised as the one of the fastest growing centres with the highest female participation in NSW. This year registrations have again increased from 120 to 140 Auskickers. Wow.... Where have all the kids come from? With thanks to our sponsors, Sancon Civil, Red Airconditioning, Redi2hire, Taylor Your Body and Sportspower we were able to purchase more playing jumpers and the equipment necessary to cater for so many kids.

We have five groups lead by our dedicated coaches to ensure that every child gets a go. With kids grouped by ability level, they practice their skills and finish the session by playing a mini AFL game. At the end of the night, lucky kids receive encouragement awards, then its sausage sizzle time before heading home.

Whenever possible during the home and away season, we organise fun games to play against other Hume League Auskick teams. Sometimes its first thing in the



morning or else they show off their skills at halftime of the senior's game, where they can play in front of a big crowd and cheer on the Bulldogs.

This year, planning is underway to organise a trip for our Auskickers to the MCG to watch an AFL match. Jindera Auskick is hosting a **Comedy Night/ Auction fundraiser** on the 9th of July at **Thurgoona Golf Club**.

The very funny Bev Killick is headlining, supported by all stars Evan Hocking and Jarryd Goundrey - 2 hours of comedy with auctions in between. Anyone over 18 can attend. Bookings are essential and can be made through Eventbrite. Search "Jindera Auskick" directly from the Eventbrite website or find the link from our Jindera Auskick Facebook page. If you and your friends would like to share a table of 8, message us via Facebook or by email: auskickjindera@gmail.com. We'd love you to get on board and support us. It will be a very entertaining night.



All money raised will subsidise the kids' trip.

It's very encouraging to see so many kids around Jindera wearing bulldogs footy jumpers. It shows great community support for footy in Jindera and promising years ahead.

More Auskick Page 7

Rural Care Link inc.

We provide a safety net of kindness, consideration and support through:-

**Jindera Opportunity Shop | Jindera Newsletter | Referral and Emergency Contact Office
Carers Support Group | Schools Grants Programmes | Critical Family Aid**

We also provide support and resources for various local events and organisations:-

The Jindera Garage Sale | Seniors Week | Anzac Day Services | Jindera Pioneer Museum

Rural Care Link Committee

New Office Bearers

President: Jonathon Howard

Secretary: Jenny O'Neill

Treasurer: Michelle Grenness

Op Shop Coordinator: Colleen Lord

Carers Coordinator: Vickie Priscina

Newsletter Coordinator: Jenny O'Neill

Assistance Coordinator: Colleen Lord

Ordinary members: Lorraine Thompson,

Elizabeth Pogson and Leeny Mason.

Rural Care Link Office

Hours

1.00pm to 5.00pm Monday to Thursday.

Assistance

We can provide basic food, clothing, equipment and other financial and emotional support should there be a genuine need.

Phone for appointment **02 6026 3001** or text **0475 594 073**. Messages responded to promptly.

The Jindera News

Published monthly (except January) by Rural Care Link Inc. All profits from advertising and donations are used to support the activities of Rural Care Link Inc.

Contributions and advertisements should be negotiated with and forwarded to the Editorial team at jinderanews@ruralcarelink.org.au

Alternatively, contact the Rural Care Link Inc. office on **02 6026 3001** or **0475 594 073**

Please Note: The editorial team reserves the right not to publish any article or to modify the presentation to suit the style of the publication.

FoodShare



Rural Care Link is now an agency for Albury Wodonga Regional FoodShare and can access their Community Pantry Vouchers, for people in need.

FoodShare's Community Pantry program was developed in response to the evolving impacts of COVID-19 to support people in the community experiencing financial hardship.



This program offers a choice between collecting a food hamper, which is packed by their volunteers, or visiting the FoodShare Shop, located in Wodonga, to individually select from their range of grocery items. These services are accessible by purchasing a FoodShare voucher, which provides excellent value for people in need.



Depending on availability, the shop and hampers contain food staples such as fresh fruit and vegetables, long life milk, fresh and frozen protein as well as non-perishable food such as cereal, muesli bars and canned food. Frozen prepared meals and some household items are also available as well as dog and cat food for pet owners.

Pet Owners

Thanks to the wonderful support of the Albury Volunteer Branch of RSPCA NSW, Rural Care Link is able to offer community pet owners in need with vital help for their pets.

RSPCA NSW believes that pets and people belong together and knows that pets bring incredible comfort and companionship, particularly during times of distress or hardship.

That's why they offer several Community Programs, providing support for elderly pet owners, as well as those experiencing domestic violence or homelessness.

The type of help available includes:-



Arranging temporary accommodation or foster care; Providing veterinary treatments; Providing transport for pets; Assisting with pet grooming; Providing safe emergency accommodation for pets; Offering veterinary services; Providing pets with access to flea and worming treatments; and supplying access to pet food and basic supplies.

If you are experiencing hardship, Rural Care Link will be here to help you and your family and your pets.



Carers Support Group

Last Month's Activities

Members of the Rural Care Link Carers Group took a surprise trip to Walla Walla in May.

Jindera Carers met up with a Henty Carer at the Thistle Café in Walla for a lovely Morning Tea, courtesy of Rural Care Link.

The chance to be out in our beautiful countryside was very much enjoyed. We looked in amazement at the artwork on the Water Tower in the township, browsed through the Walla Wares Shop while enjoying each other's company.



As one Carer responded afterwards... "The lovely day at Walla really lifted my spirits. I Didn't think I needed it but obviously did."

Peer Support and caring for yourself is so important when you are in a Caring Role.

If you care for someone....please reach out!

**The next Carer Group will meet on
Tuesday 14th June in the
Lutheran Church Hall, Adams St Jindera.**

The topic will be "Dealing with Stress" which is the first Module of The Carer Gateway - Carer Courses.

Over the next 6 weeks we will cover all six topics.

Time : 10am - 12 noon.

We invite anyone from the Hume Shire Community who is in a Caring Role to attend . If you know someone who you feel would benefit from attending, please pass this information on to them.

You may not identify as a Carer but if you are looking after someone who is aged or has an illness or disability this group is for you.

Please join us for support, information, a friendly chat and Morning Tea.

For any further info please contact:
Jenny O'Neill—Coordinator **0438 263 417** or
Vickie Priscina—Facilitator **0428 406 060**

Jindera Op Shop

Hours

10am to 4pm Tuesday to Friday and 10am to 1pm Saturday. Closed for lunch from 1pm to 1.45pm weekdays.

Wanted

New Volunteers are always welcome, as we run a very busy little enterprise. If you can spare some time and would like to be involved in helping the local community and be part of a friendly and caring team of Op Shop Staff, then please call the Rural Care Link **Office on 02 6026 3001** and make an appointment to see our Op Shop Co-ordinator, Colleen Lord.

Bargains!!!

The first 2 weeks of June we will be having a 1/2 price **sale on shoes and Jeans**. We have some really good quality items in store, so come on in and grab some bargains!

The Children's Book sale has been a huge success with piles of books walking out the door!

We still have plenty of books in stock, so we will be continuing this sale into June—6 books for 50 cents or 1/2 marked price. Why not bring the kids down and let them choose from the wonderful titles we have available.

Leading up to July, we will be presenting a range of Christmas decorations and accessories. So if you are a family that likes to celebrate Christmas In July, then we will have all the trimmings for your home and table.



ANGLICAN PARISH OF NORTHERN ALBURY

St. Paul's Jindera
Sundays - 10.00 am

Priest - The Rev'd Emily Payne
mobile : 0408 666 119
Parish office: 6040 6457

email: vicarnorthernalbury@gmail.com
website: www.anglicannorthernalbury.org. au

BURRUMBUTTOCK
LUTHERAN PARISH



Growing Where We are Planted

Sunday Worship Service Times

Bethlehem Jindera 9am

Adams Street, Jindera

Trinity Bethel, Holy Cross Burrumbuttock
and St Peter's Gerogery: please check our
website for worship times

https:burrumbuttock-parish.lutheran.org.au
Contact: Pr Christian Fandrich 0457 841 123

Gateway
LIFE CHURCH



10AM GATEWAY ONLINE
11.30AM VIRTUAL FOYER
12PM SWAHILI SUNDAY

Facebook.com/GatewayLifeChurch

😊 **BE COVID SAFE** ✓
Wear A Mask - Wash Hands
Social Distance

**St. Mary's Catholic
Church, Jindera.**

Parish Priest – Fr. P. Murphy
Assistant Priest – Fr. C. Heffernan

MASS TIMES

9.00am Sundays and 9.20am Fridays
during School Terms

Confessions available before Mass.

You're welcome at
**Lavington
Baptist
Church**

Youth Group- 13 years +
7:30 - 9:30pm

Good News Club 9 -12 years
6 - 7:30pm

Sparks 4 - 8 yrs
6 - 7:30pm



www.lavingtonbaptistchurch.com

Friday Nights during school terms
450 Parnall St, Lavington
TEL: (02) 60 215860

**Do you have an event you would like added to the
Jindera Community Diary
CONTACT US ON: jinderanews@ruralcarelink.org.au**

FREE Suicide prevention Workshop

Break the Stigma Around Mental Health, Suicide and Asking for Help

Would you know how to tell if someone you love was thinking of suicide?

In Australia we lose 9 lives to suicide each day. Studies show that between 80-85% of Australians will be touched by suicide at least once in their lifetime. Suicide is also the leading cause of death for individuals aged between 15 and 44 years of age. Does that shock you?

C. Jones Training is a business dedicated to breaking down the stigma around mental health, suicide and asking for help. Based in Holbrook NSW, our plan is to educate the greater community around suicide to ensure we have the tools to assist those we love who may be struggling.

Break the Stigma (Delivery of CALM Care) is a ½ day suicide awareness/prevention workshop that educates the community on how to respond to suicide risks in loved ones.

Participants learn;

- ◆ The facts and Myths around suicide
- ◆ How to spot when a person may be thinking of suicide
- ◆ How to ask about suicide
- ◆ And how to access services to assist the individual
- ◆ And so much more.



Upcoming workshops for Break the Stigma:

Culcairn - Saturday June 25th 2022 (25 Spots available)

Jindera - Saturday July 9th 2022 (25 spots available)

More dates coming to Greater Hume Shire towns soon

Please scan the QR code to Register

your interest or contact us today!

This workshop is FREE! (Bookings Essential)



If you would like to learn more about the “Break The Stigma” workshops search “C. Jones Training” on Facebook or contact Chantelle Jones.
E: cjonestraining@icloud.com Ph: 0459 505 934
W: www.cjonestraining.com

This workshop is supported by funding from **Murrumbidgee Primary Health Network** through the Australian Government’s PHN Supporting the Mental Health of Australians Affected by Bushfires measure.

This activity is funded by



Jindera Community Diary

JUNE 2022

SUNDAY	MONDAY	TUESDAY	WEDNESDAY	THURDAY	FRIDAY	SATURDAY
			1 <u>Social Tennis</u> – JTC - 7.00pm <u>Jindera Golf Club</u> Vets – 8.30am	2 <u>Jindera Golf Club</u> Ladies – 8.30am	2 <u>Gentle Exercise Class</u> Jindera HUB – 10.00am <u>Jindera Golf Club</u> Chook Run – 3.00 pm <u>Jindera Anglers Club</u> 5.00pm	2
5 <u>Jindera Blokes Walk</u> – Jindera Oval - 7.45am <u>Jindera Museum</u> Tearooms - 11am to 3 pm <u>Jindera Golf Club</u> - Sunday Comp. - 8.30am <u>Jindera Craft Shop</u> – 11.00am - 2.00pm	6	7 <u>Sit “n” Knit</u> Ladies Knitting Group Jindera Hub Library 10.00am	8 <u>Social Tennis</u> – JTC - 7.00pm <u>Jindera Golf Club</u> Vets – 8.30am	9 <u>Jindera Golf Club</u> Ladies – 8.30am	10 <u>Gentle Exercise Class</u> Jindera HUB – 10.00am <u>Jindera Anglers Club</u> 5.00pm <u>Jindera Golf Club</u> Chook Run – 3.00 pm	11
12 <u>Jindera Blokes Walk</u> – Jindera Oval - 7.45am <u>Jindera Museum</u> Tearooms - 11am to 3pm <u>Jindera Craft Shop</u> – 11.00am - 2.00pm <u>Jindera Golf Club</u> - Sunday Comp. - 8.30am	13 <u>Museum Meeting</u> - School of Arts Hall - 7.30pm	14 <u>Sit “n” Knit</u> Ladies Knitting Group - Jindera Hub Library 10.00am	15 <u>Jindera Golf Club</u> Vets – 8.30am <u>Social Tennis</u> – JTC - 7.00pm <u>CWA</u> - School of Arts Hall - 10.00am	16 <u>Jindera Golf Club</u> Ladies – 8.30am	17 <u>Jindera Golf Club</u> Chook Run – 3.00 pm	18
19 <u>Jindera Blokes Walk</u> – Jindera Oval - 7.45am <u>Jindera Museum</u> Tearooms - 11am to 3pm <u>Jindera Craft Shop</u> – 11.00am - 2.00pm <u>Jindera Golf Club</u> - Sunday Comp. - 8.30am	20	21 <u>Sit “n” Knit</u> Ladies Knitting Group - Jindera Hub Library 10.00am	22 <u>Jindera Golf Club</u> Vets – 8.30am <u>Social Tennis</u> – JTC - 7.00pm	23 <u>Jindera Golf Club</u> Ladies – 8.30am	24 <u>Jindera Anglers Club</u> – 5.00pm <u>Gentle Exercise Class</u> Jindera HUB – 10.00am <u>Jindera Golf Club</u> Chook Run – 3.00 pm	25
26 <u>Jindera Blokes Walk</u> – Jindera Oval - 7.45am <u>Jindera Museum</u> Tearooms - 11am to 3pm <u>Jindera Craft Shop</u> – 11.00am - 2.00pm <u>Jindera Golf Club</u> - Sunday Comp. - 8.30am	27	28 <u>Sit “n” Knit</u> Ladies Knitting Group - Jindera Hub Library 10.00am	29	30		

JINDER NEWS - CONTACT US ON: jinderanews@ruralcarelink.org.au

Friends in Action (Caritas) Diary:

2022

A Group that can offer emotional and spiritual support and opportunity for growth through caring and personal relationships.

With adhering to Covid-19, Rules and what we can do, check out email notices, please. Staying Safe.

8th June

Wandering in Wodonga.

Meeting at St Paul’s Jindera at 9.30am.

Morning tea 10am at Bean Station old Wodonga station.

HYPHEN Gallery/library exhibitions look see talk/tour at 11am.

Lunch 1pm Elgins.

Contact: Annette on 0456 370 257 OR Roz on 0417 457 122.

Leader: Jane Barlow 0438 262480

Assistant Leader: Roz Phillipson 0417 457122

Secretary: Annette Brown 0456 370257

Treasurer: Bev Blair 60 262431

Have Your Say



Draft 2022 - 2026 Delivery Program, Draft 2022-2023 Operational Plan, Draft 2022-2026 Budget, Draft 2021-2025 Disability Inclusion Action Plan, Draft 2022-2026 Resourcing Strategy and Draft 2022-2023 Fees and Charges.

\$46m - Total Budget

- \$12m - Capital Works
- \$33.7m - Operating Expenditure (excl. depreciation)
- \$6m - Recreation & Culture Facilities
- \$4.4m - Community Service Activities
- \$18.2m - Road, Bridge and Footpath Projects
- \$6.2m - Water and Sewer Services
- \$2.4m - Environmental Protection Activities

Talk with Us

David Smith, Director Corporate and Community Services will be available to take your comments/feedback, answer questions and discuss various aspects of the draft plans and strategies on exhibit on the following dates:

- Wednesday 8 June, 9 to 11 am, Jindera Community Hub
- Wednesday 8 June, 2 to 4 pm, Holbrook Library
- Thursday 9 June, 9 to 11 am, Culcairn Library
- Thursday 9 June, 2 to 4 pm, Henty Library

View the various plans and strategies at greaterhume.nsw.gov.au and comment on the [Have Your Say](#) page, or email mail@greaterhume.nsw.gov.au or write to General Manager, PO Box 99, Holbrook 2644.

Comment on the various plans and strategies up to 5.00pm Thursday, 16 June 2022.

Greater Hume Council

Photo: @Lea_Bic Photography

Auskick in Jindera

If you or someone you know would like to be involved in Jindera Auskick here all the contact details.

To register for Auskick go to the following website www.playhq.com/afl/org/jindera-australian-football-centre/43e576d9/register

Or for further information Phone 0418 861 108 or visit the Auskick Facebook page at: www.facebook.com/jinderafootball





Little Saints Preschool

Phone: (02) 6026 3908

Email: littlesaints@stjls.nsw.edu.au

Address: 154 Adams St, Jindera NSW 2642

At Little Saints, we have been taking many opportunities whilst the weather is still nice to get out in our community.

We recently went to Pioneer Park for a play and picnic lunch.

The children enjoyed sharing with us stories of recent birthday parties they have had there or times their Mum's, Dad's or Special people in their lives when they had brought them to the park.

We are currently taking enrolments for 2023.

Please call 02 6026 3908 to book your tour.



**CALL TODAY TO ARRANGE A TOUR FOR NEXT WEEK!
LIMITED SPOTS AVAILABLE FOR 2023!**

📞 02 6026 3908

🏠 154 Adams St, Jindera NSW

🌐 www.stjls.nsw.edu.au/lsp



Justin Clancy MP

MEMBER FOR ALBURY

02 6021 3042 | albury@parliament.nsw.gov.au | justinclancy.com.au | Authorised by Justin Clancy and produced using Parliamentary Entitlements.

JINDERA COMMUNITY FORUM

Next **General Meeting** is at the **Jindera Community Hub** (entry via rear carpark)
on
******* Tuesday, June 21, 2022 *******
******* 7:30pm *******



Come and join a group of locals who are interested in our community and its people, and who would like to help improve the facilities our community offers to both visitors and residents alike.

SPECIAL **COMMUNITY MEETING**

to discuss the Jindera Community Hall

at

JINDERA COMMUNITY HUB

(83 Urana Street—entry via rear carpark)

TUESDAY, JUNE 28

6PM

This meeting is for anyone interested in having input into a **Jindera Community Hall**, or who would like to be part of a new committee to move this 20 year old concept into a reality.

Letters will be going out to Community Groups inviting feedback and/or attendance at this meeting, and it would be beneficial for Jindera if everyone had some input.

(Enquiries to Kathy Anderson on 0407 357 082 or Pat Hayes at the Post Office)



For more information contact:
jinderacommunityforum@gmail.com



JINDERA PUBLIC SCHOOL

School Mini Athletics Carnival

We recently completed the school's mini athletics carnival for students to practice and compete in events leading up to our school athletics carnival held at Les O'Brien Sports Precinct later in the term. This annual event allows the school to select finalists for shot put, discus, long jump and high jump and, as expected, the students participated with high levels of enjoyment and competitive enthusiasm. With the weather holding out for the day, we were just able to complete our last events before the rain, once again, settled in.



Walk Safely to School Day

On Friday May 20, the students from Jindera Public School were given the opportunity to participate in the Walk Safely to School event. This day is organised to raise awareness and promote physical activity and to provide students and families with a starting point to increasing physical activity and promote healthy lifestyle choices. Thanks to our families, staff and bus companies for supporting this event and assisting to make the walk another success.



Do it for Dolly Day

Our school Student Representative Council met recently and decided to support Do it for Dolly Day. This is now an annual event, coordinated to help raise awareness, and dedicated to bringing the community together, spreading kindness and uniting in taking a stand against bullying. This year, our school wore blue to support this day and raise money to help support this very important cause.



School Athletics Carnival

Midway through term 2, the primary aged students from the school travelled to Les O'Brien Athletics Precinct to participate in the school's main athletics carnival. Students engaged in running and field events with many children pushing themselves to participate in most of the events. This day has also allowed us to select our school team to participate in the upcoming Southern Riverina Athletics Carnival to be held later in the year.

Congratulations!

Well done Danny Mitchell, who recently took part in the Southern Riverina Cross Country as part of the Jindera Public School team. Danny has been successful in reaching the next level and will soon take part in the Riverina Cross Country to be held in Gundagai later this term.



SNAPSHOTS



OF LEARNING AND FUN

Persevere
with sincerity.



Avondale Place
COMMUNITY CARE

Henty's new respite centre Avondale Place to start construction

We encourage you to reach out to us if you are:

1. interested in becoming a donor
2. interested in becoming a volunteer
3. considering a career in respite care
4. intending on or considering accessing care at Avondale Place

www.avondaleplace.com.au

hello@avondaleplace.com.au

Mick Broughan T: 0447 293 286

Mary Liston T: 0428 293 493

Ben Hooper T: 0431 419 729

FOR CARERS & THOSE IN NEED OF CARE

The service provider will work to design the care that best meets individual needs. This will allow those in need of care and carers to avail of respite.

Qualified and caring staff will ensure the facility caters for a diverse range of needs.

Care will be offered from short-term, such as day to day as regularly as required, through to longer-term care for when regular carers need a break.

Accommodate options will include full time care for short term respite in Avondale Place and 4 independent assisted living units offering longer term options.

FOR THOSE SEEKING EMPLOYMENT

Avondale Place is ready and willing to provide guidance and hands on training to those who are genuinely seeking a variety of employment opportunities.

ARE YOU INTERESTED IN VOLUNTEERING?

Avondale Place is a community project and facility. There will be plenty of opportunity for community members to make a meaningful contribution and assist with those accessing respite.

APPROVED PLANS

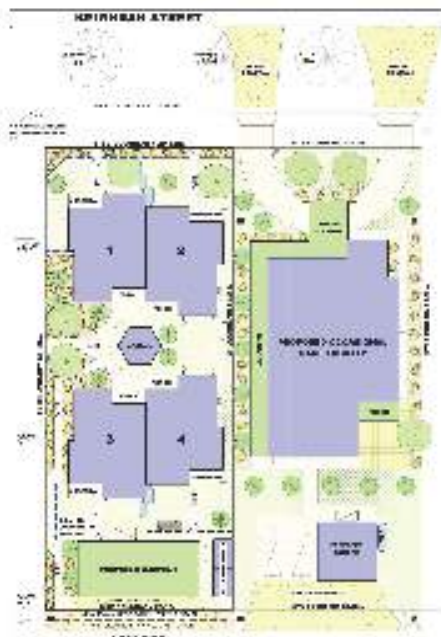

A community funded, purpose built homestead and 4 independent assisted living unit.

CENTRAL LOCATION



*A serious project
requires serious
support!*



FUNDING REQUIRED 25%

DONATE TODAY

70 people donating \$5,000
\$350,000

350 people donating \$1,000
\$350,000

or donate at your discretion

Avondale Place holds DGR status meaning all donations are tax deductible

HOW DO I DONATE

Call in to the
Henty Bendigo Bank

or

Direct Deposit

Acc name: Henty Respite Ltd
BSB: 633 000

Acc No: 186 764 304

or

Visit

www.avondaleplace.com.au

*All donations are tax
deductible.*

Thank you

Thank you to everyone who supported the **Cake Stall and Wood Raffle** last Saturday, whether you baked, bought raffle tickets or donated money. **\$1,200** was raised for Cancer Council which is a mighty effort. Thank you to Jono Schulz for donating the trailer of wood. Ian Scott was the winner of the raffle.



The Rural Care Link cake stall



Shirley Finster, Jonathon Howard, Jenny O'Neill & Cheryl Ingrey

Jindera CWA News

Eight members of Murray Group attended the 100 year CWA of NSW Conference at Randwick Racecourse in Sydney.

The Conference was opened by Honourable Margaret Beazley, Governor of New South Wales. Key-note speakers were Layne Beachley, seven times World Surfboard Champion and Commissioner Shane Fitzsimmons, Australian Fire Commissioner and Head of Resilience NSW.

The Randwick Racecourse venue was very adequate and fitting for the Conference, with all exhibits bring held under one roof.

Stephanie Stanhope, the outgoing State President, presented a donation for \$21,000 for research into Ovarian Cancer.

The new State positions are: President – Joy Beames. Secretary – Pam Wright, Treasurer – Sharon Buck. Vice Presidents – Ann Adams and Bronwyn Dunstan.

Congratulations to Albury Evening Branch receiving a Highly Commended Award for service in their area.

COUNTRY OF STUDY THIS YEAR IS LATVIA.



L-R Members and Branch in Murray Group. Barbara McKenzie (Glen Mannus) Lyn Buck (Murray Group President) Genevieve Knobel (Gerogery) Jeanette Findley (Gerogery) Janet Drummond (Tabletop) Judy Haines (Albury Evening) Heather Kerr (Oaklands) Olivia Hanel (Jindera).

Next Year 2023, State Conference will be held in Bathurst from 8 – 11th May.

Yours in CWA Friendship.

Bev. Blair - President



Well know Jindera local on the mend!

One of Jindera's senior citizen, Mrs. Mary Fielder who celebrated her 97th birthday in May, suffered a fall which badly damaged her hip.

She is now convalescing in Wodonga and is on the mend.

CWA members sent her some get well flowers and our very best wishes for a speedy recovery.

Mary Fielder



Year 5 and 6 leadership teams. We have groups of students who want to lead across our community. Some choose to lead students and some lead behind the scenes. Here is one such group getting meals prepared (with the help of an amazing parent) for those who require or are in need in our community. They are then distributed as and when.



These students prepared, cooked and baked some delicious meals. The collaboration that took place grew as they worked on their communication through the time together and they had to show grit and determination in peeling, stirring and not eating! We are proud of you and grateful you are showing empathy across our community.

**LEARNER PROFILE
OF A ST JOHN'S STUDENT**
*Our Learning Characteristics for a Collaborative,
Thriving and Inspiring Learning Community.*

**I THINK DEEPLY,
CRITICALLY
AND CREATIVELY**

I can:

- reflect on my thinking and learning
- set goals to drive growth in my learning
- create and consider a wide range of possibilities and solutions

**LEARNER PROFILE
OF A ST JOHN'S STUDENT**

*Our Learning Characteristics for a Collaborative,
Thriving and Inspiring Learning Community.*

**I HAVE GRIT AND
PERSEVERANCE**

I can:

- use feedback to improve my thinking
- view mistakes as learning opportunities to grow and move closer to my goal
- be strong in my sense of self and appropriately respond to my emotions

Project based learning.

This is in full swing across K-6 giving authentic experiences to equip our students to problem solve into the future.

Across Year 1 and 2 they have continued exploring possible solutions to solve the problem of what to do with the old school uniform as part of our wider inquiry into how to take care of the environment and inspire others to help us. We have had the pleasure of welcoming some special visitors to our classroom over the past two weeks to talk about their ideas for the uniform. Thank you so much to all those who dropped in, emailed and sent letters with such fabulous ideas!



Year 1 and 2 had visits from Tracey who said the uniform could be made into bears, Carmel and Toni (Parents) who shared that our old (good quality like new) uniform can be used by other children in Vietnam. Now they will be working hard preparing to share their solutions with the school community, so watch this space!

The Kinders have been doing a History focus with the PBL called 'All About Me'.

They have been finding out all about themselves and their families. Looking at where they were born, where their families are from, where their name came from and the stories that special objects and photos can tell about a person. Pictures showing our first excursion down to the Jindera Pioneer Museum to look at other people's special objects and photos and saw what stories they tell about someone's life and about what the past was like. It was lots of fun!



Volunteering at STJLS and connecting with families.

It was fantastic to have our Kindergarten class lead our Mother's Day Chapel a few weeks ago. It was also so good to have families engaging and connected with our staff and classrooms. I strongly encourage parents or members of the community to volunteer to help out in our school whenever you are available. All volunteers require a Working with Children Check and to complete our Valuing Safe Communities online training module. Please contact the front office for further information.





Campfire Night at the Jindera Museum gets toes tapping and hands clapping!



The Jindera Pioneer Museum held another successful event in their Campfire Night which was held on the grounds last Saturday May 14.

The crowd were well entertained by the great music of the Swag and Bush Band and whirled and stomped around under the corrugated iron roof of the old carts and wagons shed at the rear of the attraction.



“The museum has held a campfire night for several years now, except in 2020 with Covid restrictions,” said museum president Margie Wehner.

“These sort of nights aren’t possible without all of our wonderful volunteers and the people behind the scenes and the success of this event is a credit to them.”

“In past years, patrons have been enthralled by a mighty bonfire as well as the great music and hearty camp-oven cooking and spit roast lamb, however this year, with all the rain, the bonfire wouldn’t light.”

“Thankfully the rain for this event was only minimal throughout the day and on the night, so the spit still managed to cook and the camp-ovens produced fabulously tasty and aromatic food that was enjoyed by all attending.”



During the event at this world class museum, small campfires burnt in tubs around the site, many keeping the camp-ovens hot until eating time arrived.

Damper accompanied this great feast and billy tea was on hand for anyone interested although organisers can report most preferred a drink of a different colour and temperature!

“Everyone loved the music from this interesting collection of musicians and singers,” said Margie.

“Each year the band is pledged to consist of four players and each year eight have turned up, playing a wide variety of instruments throughout the night accompanied by good voices and harmonies.”

Those attending couldn’t help but tap and clap along and, when the music blew the nerves away, dancing was the flavour of night, surrounded by the magic of yesteryear with historic agricultural machinery the dusty backdrop.



“There was even some dance calling and intertwining of folk through old twists and moves and all agreed, in general, a very good time.”

The weather was mild for May, one bonus of the cloud cover from the wet days before, but this didn’t dampen the spirit of those attending this fun filled night in a beautiful location dedicated to Jindera’s early foundations.



SUSPECT EVERYONE

St Mary MacKillop College presents
London's longest running play!

THREE SHOWS ONLY!

Jindera School of Arts Hall, Urana St

Fri 17 June, 7pm

Sat 18 June, 1pm Matinee

Sat 18 June, 7pm



Adults.....\$15

Children & Conc ..\$10

Families\$40

www.trybooking.com/BZOWI



THE AGATHA CHRISTIE'S M~~E~~MOUSETRAP

JINDERERA

• PIONEER MUSEUM •

We have seen our first coach group return to visit the museum in over two years. This was a tour passing through the district on their way from Sydney to Melbourne, so we were pleased to be able to engage them during a stop-over in Jindera. We have also seen some larger school groups return this term, having only had small class groups from St Mary McKillop College in past months.

Although the recent nights have a distinct winter quality, we are still getting some gloriously warm autumn days and this has been very conducive for visitors to take their cuppa and Devonshire Tea into the museum garden on a Sunday.

The **Tea Room** seems to be the highlight of Jindera on a Sunday with many visitors stopping over on their way here or there or coming specifically to indulge in the great home cooked delights the Tea Room has to offer. Despite their being no espresso machine, the coffee is also pretty good.



Mother's Day was again a popular day for the Tea Rooms, with our largest number of people attending for lunch or just coffee and cake or Devonshire Tea. There was no rain and people could sit in the garden or on the veranda and watch the world go by.

A new seat is to be installed around the large oak tree behind the main residence and compacting and paving will enhance this area. A new garden bed has already been created and, in time, this will add some beauty to this new area.



The **Campfire Night** was the highlight of this month with our largest crowd at this event, all snug in the horse-drawn and agricultural machinery space, a perfect setting for a bush-band and camp-oven cooking. See the article featuring this event on page 16 of this Jindera News.



The All-abilities toilet is well on the way to completion, with internal fittings, power connections and outside concreting the last of the requirements to be completed. We should see this project operational by the end of this month.

Several larger maintenance jobs need attention and ways to bring the Glenellen school to the site are being considered.

There are always things to be done around the site; the buildings are old and the materials are often failing, there are also always new and different concepts for displays being considered and new items coming into the collection. The museum is an interesting and evolving environment to get involved in, come and join us.

Margie Wehner

President

Jindera Pioneer Museum & Historical Society Inc.

Experience the Pioneer Lifestyle

Set on 2 acres, featuring multiple dwellings and beautiful gardens, we welcome you to come take a trip back to life 150 years ago





OPEN from
10am - 4pm every day
(October to April)

Tea Room Open every Sunday from 11am

www.jinderamuseum.com.au

118 Urana Street, Jindera, NSW

P: 0408 409 842

JinderaPioneerMuseum

JINDERA TYRE SERVICE

129 URANA STREET JINDERA 02 6026 3400



KUMHO TYRE
Better. All-ways

OFFICIAL SUPPLIERS



Albury Return and Earn
Automated Depot and
Billabong Recycling Pty Ltd

- Get your 10c refund for your eligible containers
- Have them from picked up from your door
- We can supply you bags or tubs
- Drop them off to us at 11 Catherine Crescent, Lavington
- We can process your containers at Lightning speed
- Your refund goes straight to your bank account
- We can give you charity bins for your school or business
- Perfect for fundraising initiatives

Our mission is to make the world a better place by recycling as much as we can, and we would love you to join us on our journey.

0447 927 722 or 0493 206 629

We also sell 100% Recycled Paper Brick Fire Extenders and Kindling



Jindera Blokes Walk

Thank you to everyone that supported our 1st ever Jindera Blokes Walk (JBW) raffle in particular Cade, Renae & Heather from **Conway Printing** for donating the tickets.

Special thanks to both **Next Level Cafe** and **Jindera IGA** for their ongoing support of JBW. The draw was completed with JBW members Stax, John and Mick drawing the 3 lucky tickets from the 200 sold. All proceeds from this raffle go back into the JBW group and help with our mission to promote Physical and Mental fitness in local blokes through social connection.

The winners are -

3rd prize: Glen Campbell \$50 voucher Next Level Cafe
2nd prize: Archie Henderson \$100 voucher Jindera IGA

1st prize: Glen Campbell \$500 goods/services to a Jindera owned or operated business.

Congratulations to the winners. Following Glen's win he chose to treat himself to a couple of new tyres on his ute. It was a great feeling dropping into Jindera Tyre Service and handing over \$500 to Brad as a result of the Jindera Blokes Walk raffle and supporting local business in our great town .



PESTS?

Spiders, Termites, Rodents,
Carpet Beetles, Ants, Fleas
Wasps or **WORSE?**

We Can Help!

- Domestic & Commercial Pest Control
- Timber Pest & Building Inspections
- Termite Treatments
- Thorough Written Reports
- Free, No-Obligation Quotes
- All work Guaranteed

www.piantospestcontrol.com.au

office@piantospestcontrol.com.au

VIC Lic No. L005632 | NSW Lic No. 5091710

Jindera, Burrumbuttock, Holbrook, Albury-Wodonga,
Corowa, Rutherglen, Wangaratta, Howlong,
& surrounding areas.

Pianto's
Pest Control

Pianto's
Pest Control

Phone: 02 6032 7137

(02) 6032 7137



SHOP
in
JINDERA

Civil Celebrant

—Judy Gray—

•Weddings •Baby Namings •Funerals

Conducted in Style

TELEPHONE: 6026 3329

MOBILE: 0418 617 385

see your
ad here

Contact Jindera News
for pricing & more info
[jinderanews@
ruralcarelink.org.au](mailto:jinderanews@ruralcarelink.org.au)



"FOR ALL YOUR PRINTING REQUIREMENTS"

- Business Cards • Letterheads • Books • Raffle Tickets
- Complete in-house design service • All business stationery
- Invoice Books • Stickers • Brochures • Leaflets

(02) 6026 3611

RECEIVE

THE JINDERERA NEWS

BY EMAIL

YOU COULD RECEIVE THE JINDERERA NEWS BY EMAIL, JUST SEND A REQUEST TO

jinderanews@ruralcarelink.org.au

And each Month (except January) the Jindera News will be sent to the email address noted as the sender in your email

Please note that the file size can vary from 6 to 10Mb



MICK'S TREE HEIGHT REDUCTION & SHAPING SERVICES

SPECIALISING IN:

TREES - felling/lopping
/pruning & removal

**PRUNING &
STUMP GRINDING**
- hedges/bushes/shrubs
/roses & palm trees
(chipping available)

OTHER SERVICES -
gutter cleaning/
rubbish removal

**Special
Discounts
for
Pensioner
Services**

MICK: 0427 316 497

Proficient Home & Yard MAINTENANCE

Allen Davison

0473 386 371

Servicing Albury / Wodonga and surrounds.

No Job too Big or Small
All inquiries Welcome

Local Jindera Business!



BOBCAT WHILEY

■ Bobcat with Trax ■ Trencher ■ Hay Spikes
■ Post Hole Digger ■ Excavator ■ Tip-Truck
■ Slasher

PHONE GEOFF: 0408 698 028
Dights Forest Road, Jindera, NSW 2642

(02) 6026 3990

Greater Hume Council appoints new General Manager for five year term



Evelyn Arnold

With the impending retirement of Council's long serving General Manager, Steven Pinnuck, following an extensive recruitment process Council has appointed Evelyn Arnold to the position for a five year term.

Mayor, Cr Tony Quinn said that whilst Greater Hume Council will be Evelyn's first appointment to a General Manager/CEO role, Evelyn has significant senior management experience in Local Government in Western Australia and most recently as Director Community and Corporate Services at the Shire of Southern Grampians in western Victoria.

Cr Quinn said that Evelyn beat a very strong field of applicants for the position and is the right person to take the Council forward and capitalise on the significant growth opportunities for the Greater Hume area.

We are delighted to be welcoming Evelyn to Greater Hume Council and are confident in her ability to deliver on Council's ambitious Council growth plans and community expectations."

Ms Arnold expressed her delight at having the privilege to lead Greater Hume Council in this next exciting chapter. "It is an honour to accept this appointment and I very much look forward to working with the organisation, the Councillors and the community".

Evelyn Arnold will take up residence in Holbrook in early July and commence with Greater Hume Council on Monday 11 July. Council's Director Corporate and Community Services, David Smith will Act as General Manager from 2 July 2022 until Evelyn Arnold's commencement.



You will save stacks of money when you shop locally in Jindera.



Have Your Say

Annual survey on cross-border issues!

Share your experiences working or living in NSW's cross-border communities

The [Cross-Border Stakeholder Survey 2022](#) will take less than 10 minutes to complete
The survey closes at midday/12pm AEST Tuesday 14 June 2022

You are welcome to complete this survey if you:

- Live or work in a NSW border community
- Had an interaction with our office in the past three years
- Have not had any interaction with our office, but have views on NSW cross-border issues

The information that you share with us will be collated to provide a picture of your experiences with the Office of the Cross-Border Commissioner and your views on the key issues faced by people living and working in cross-border communities.

We would like to hear from as many people connected with NSW's cross-border communities as we can. You are welcome to share this survey with your personal and professional networks.

To learn more about our work with border communities, please visit our website at:
www.regional.nsw.gov.au/our-work/ocbc

Please feel free to contact us if you have any further questions
Email: enquiries@cbc.nsw.gov.au - Post: PO Box 1156, Wagga Wagga NSW 2650





Plumbers, Drainers & Gasfitters
Bobcats, Excavators, Tippers & Trenchers
Farm Water Supply
Reticulation, Trenching
Troughs, Tanks & Solar Pumps
Septic Systems
Septic & Trade Waste Pumping
Sand & Gravel Cartage
Grader & Water Cart Hire

**If you want to dig it, pipe it, pump
 it or fix it – we can do it!**

Mobile: 0403 191 780
www.blueysplumbin.com.au



**YOU'RE ONE OF A KIND.
 SO ARE WE.**

St Paul's offers a balanced approach that prioritises academic pursuits while also preparing students for life beyond the classroom. Our Discovery Day will host parent tours and a full day of activities for Year 5 students.

"My child has a real sense of belonging and I feel part of a partnership and community working as a team for his best outcomes." - Parent of St Paul's.



**ST PAUL'S
 COLLEGE**
 WALLA WALLA, NSW

For more information, please call (02) 6029 2200

YEAR FIVE
**Discovery
 Day!**

Thursday, 23rd June 2022

Year 7 enrolments
 for 2024 open this day

Bookings are essential for Discovery Day
 via QR Code, www.trybooking.com/BZFEQ
 or visit www.stpaulscollege.nsw.edu.au



Lester & Son
Funeral Directors

A tradition of personal, professional care since 1907



Cherie, Tony, John

359 Wantigong St
Albury
02 6040 5066

www.lesterandson.com.au

All Hours • All Areas • Pre-planned Funerals Available



TerryWhite Chemmart.

Jindera TerryWhite Chemmart Pharmacy

Shop 4&5, 82 Urana Street, Jindera, NSW 2642

OPEN

Monday-Friday: 9.00am to 5.30pm

Saturday: 9.00am to 12 noon

-- OFFERING --

- ◆ Health Risk Screening Services
- ◆ National Diabetes Services Scheme
- ◆ Webstar packing
- ◆ Spotcheck (Skin Cancer Screening Programme)
- ◆ Wide range of vitamins
- ◆ MedsCheck
- ◆ Free Blood Pressure Testing
- ◆ Baby Products
- ◆ Home Health Care Aids
- ◆ Giftware
- ◆ Natio Ski Care range
- ◆ Chemmarts Reward Programme

Phone (02) 6026 3271

Fax: (02) 6026 3935

Email: Jindera@chemmartpharmacy.com.au



TerryWhite Chemmart.





Jindera Village Post Office

For postal information and product specials

Bank with over 70 banks and financial institutions

Phone:
6026 3201



Wattos Garden Supplies
1 Jarick Way

Jindera Industrial Estate

Earthworks now Available

We also offer Deliveries

0448 600 433



St Paul's Anglican Ladies Knitting Group

Sit "n" Knit

Tuesday 10.00 to 11.30am

Jindera Community Hub Library

Join us to knit for a charity or bring
your own knitting project

(if you can't knit we'll show you)

All welcome



for more information phone 0400 424 437



OCCUPATIONAL THERAPY

Alison Viedt

0427 263 398

alison@equipoccupationaltherapy.com

see your
ad here

Contact Jindera News
for pricing & more info
[jinderanews@
ruralcarelink.org.au](mailto:jinderanews@ruralcarelink.org.au)



Bank Brighter.

humbank.com.au/bankbrighter

Hume Bank

FUGE EARTHWORKS PTY LTD

- SCRAPERS • DOZER • LOADER • EXCAVATOR
- GRADER • TIP-TRUCK • TRAXCAVATOR
- ROLLER & BACKHOE FOR HIRE



- Dam Construction, Enlargement and Repairs
- Site Excavations, Drainage, Driveways
- Bulk and All General Earthworks

MICK FUGE: 0428 480 341

Ph/Fax: (02) 6026 3571. Email: fuge.1@bigpond.com
375 Molkentin Road, Jindera, NSW 2642.

JINDERA BUTCHERY

Quality Meat & Personal Service
– Bulk Meat Specials –

Brad & Tina Taylor
Shop 7, 87 Urana Rd,
Jindera, NSW 2642 (02) 6026 1886

Please follow all COVID requirements during your daily activities and practice social distancing.

Stitch and Chat Craft Group

This group meets on the first Wednesday afternoon of each month at 1.30pm at the Jindera Anglers Clubhouse.

All welcome, just bring whatever you are working on and come along for a chat and cuppa.

We usually finish at around 3.00pm

Judy Gray on 0418 617 385 for further information.



COOEE BOOKKEEPING

Contract bookkeeping for small to medium businesses
Xero and MYOB

Judith Hudson

0431 027 268

judith.hudson9@gmail.com



Jindera Community Garden

Please message
Eileen White - 0400 023290

You may join the
Jindera Community Garden Group
 on Facebook with more updates
Happy Gardening Everyone!

Mother's Day Stall



Thanks everyone for your wonderful help to make this happen. Helen your little boiled Fruit Cakes were very tasty thanks heaps for your generosity. Thanks Elizabeth your plants were very decorative pleasing to the eye Thank you. Thanks, Cathy, for organising our raffle gifts & vouchers it was a great effort for you to achieve these goodies.

Mother's Day Raffle Winner

A lovely lady from Kiewa won the First Prize. Robert won the Second Prize which was a Voucher from **Jindera Hair Health and Beauty.**



Thanks Allen and guys for all your skills in handling this amazing machine so we can have a Wood Raffle in July

It's all happening in the Shed



Thanks, Peter, for the fiddly bits you have been doing in the shed it all takes time. Thanks, Gary, for your time and energy in organising the steel for the veranda on shed can't wait to see it finished.



Easy Kitchen Tip
 Place a Bay Leaf in
 Flour, Rice and Pasta to
 keep the critters out!

Riverina Plants
 and Gardening
 have lots of ideas
 for your garden
 projects



There may not have been much action in the garden lately but there has certainly plenty of action happening in the background organising heaps of people and ideas to be put in place for July and August. Jindera Community Garden is currently looking for a Secretary and/or someone to volunteer for posters ... labels. thankyou letters ... which they can do in their own home. There are heaps of jobs to be done and it's not digging in a garden. We have been in contact with Centrelink for volunteers who may wish to get extra payments if you qualify, just waiting for code numbers. In the meantime **Happy Gardening!**

Do you know someone who would benefit from having a homecooked meal?



Pick up or delivered Call 0421 706 578

Get your meals sorted for the week!

Meal packs are now available to order
We have a meal pack to suit every lifestyle
Healthy & cooked fresh, ready to heat & eat

Easy online ordering

www.dotskitchens.com

to see our menu & order

Or call us on 0412 706 578



NA Auto

AUTOMOTIVE ELECTRICAL
SPARE PARTS AND ACCESSORIES

Neil and Kathy Anderson
94-96 Urana Street PO Box 27 Jindera NSW 2642
Ph: 02 6026 3391 Fax: 02 6026 3722 Mob: 0428 578 061
Email: sales@naauto.biz Website: www.naauto.biz

JINDERA HAIR HEALTH & BEAUTY

TEL: 02 6026 3434
91 Urana Street, Jindera

BLD Machining

CNC MACHINING FABRICATION & WELDING

Precision:
Milling, Boring & Screwcutting,
Repairs, Maintenance & Modifications
to all plant & equipment

Guaranteed fast and professional service.

Phone Bruce:
0448 790 666
6 BEGG DRIVE, JINDERA
*Fixing the old and broken, designing
and manufacturing the new!*



Jindera Vet Clinic

Phone: 02 6026 3277 Email: clinic@jinderavet.com.au
Hours: Mon-Fri 8.30am-6pm Sat 8.30am-11am
89 Urana Street, Jindera NSW 2642

Daryl Klein B.V.Sc.(Hons) Veterinary Surgeon
Britig Pitman B.V.Sc.(Hons) Veterinary Surgeon

With the bonus of wonderful staff!



McMillan Electrical

Craig McMillan
All Electrical Services

📍 PO Box 477, Jindera, NSW
✉ mcmillanelectrical44@gmail.com
☎ 0418 966 207

NSW License 151911C
VIC License REC-31010



The 2022 season is well underway, together with the cooler weather, although we have been blessed so far with some beautiful sunny days for playing golf. We have played two rounds in the club championships so far, with the third scheduled for Sunday 5th June.

With winter “officially” arriving shortly, Sunday 5th June will see the Sunday comp tee time changing to 11:30/12:00 until September.

AND don't forget, we are now running a “9 Hole” comp in conjunction with the normal 18 hole Sunday comp for those who only wish to play 9 holes – handicap is not required and scores will go towards getting a handicap. Tee times follow the usual Sunday comp.

Friday Chook Run is still running, although with earlier tee-off of 3.00/4.00 pm. You can also play earlier in the week if you wish, just find a partner, play your round and place card and \$5.00 under the door.

In the meantime, current comps are as follows: -

- **Sunday** – Men's 18/9 holes, event according to calendar on website Tee-off 8.30/9.00. (11.00/12.00 from June)
- **Wednesday** – VETS 9 Holes, Stableford (unless notified differently) Tee-off 8.30/9.00
- **Friday** – Chook Run – 9 Holes, Open to all, Tee-Off Currently 3.00/4.00, can also be played throughout the week – Play your game, place cards – signed and verified by partner with \$5.00 in an envelope and slide under the door.

Membership - As mentioned previously, the number of social golfers using our course – and paying Green Fees - seems to be growing every week, which is great for the golf club and the community.

Season 2022 membership renewals have been sent out, with GST added to the cost of memberships this year, bringing the cost of adult memberships to \$110.00 (inclgd GST) and \$33.00 (inclgd GST) for juniors.

Please support your community golf club and renew your membership via the payment details on the invoice.

*Happy golfing ...
... get a friend or take the family along
and enjoy the Jindera Golf Course!*

SCORES

SUNDAY COMPETITION

SUN 1/5/2022 – May Monthly Medal – Stroke – 27 Players,
Medal Winner Strop Weldon,
9 Hole Comp Stableford Winner – Strop Weldon

Name	Dly Hcp	18 Comp Gross	18 Comp Score Net	18 Comp Result	9 Comp Score Stbl	9 Comp Result
Strop Weldon	30.0	99	69.0	w medal	20	W\$20
Greg Preston	22.0	93	71.0	r/u cb \$20	16	
Rhett Prescott	28.0	99	71.0	B	19	r/u 2b
Daryl Klein	22.0	94	72.0	B	17	
Nev Brand	23.0	95	72.0	B ntp	16	
Ash Paech	10.0	85	75.0	B	17	
John Metcalf	12.0	87	75.0	B	15	
Greg Allen	14.0	90	76.0	B	16	
B. Polkinghorne	16.0	93	77.0	B	18	
Chris Larkin	23.0	100	77.0	B	14	
Simon Cossor	15.0	93	78.0	B c/b ntp	15	
Bob Sheerans	20.0	110	90.0	ntp	10	

SUN 8/05/2022 – Stableford – 12 Players, 18 Hole Winner 'Doc' Klein
9 Hole Comp Stableford Winner – Greg Preston

Name	Dly Hcap	18 Score	18 -Result	9 Score	9-Result
Daryl Klein	22.0	37	W \$20	17	
Greg Preston	22.0	34	r/u cb \$15	18	W cb \$20
Trev Freeman	20.0	34	B	16	
Josh Little	33.0	33	B	18	
Aaron Melbourne	27.0	32	B	18	r/u 2 b

SUN 15/5/2022 –

Stableford – 13 Players, 18 Hole Winner - S. Cossor
9 Hole Comp Stableford Winner – Mihi Smith

Name	Dly Hcap	18 Score	18 -Result	9 Score	9-Result
Simon Cossor	16.0	40	W \$25	19	
Strop Weldon	29.0	39	r/u \$15	20	
Ron Smithenbecker	15.0	32	B	16	
Josh Little	33.0	31	B	21	r/u 2b
Garry Spurr	28.0	30	B	13	
Mihi Smith	45.0	0		21	W \$20

SUN 22/5/2022 –

Stableford – 13 Players, 18 Hole Winner Gary Spurr ,
9 Hole Comp Stableford Winner – Gary Spurr (Front 9)

Name	Dly Hcap	18 Score	18 -Result	9 Score	9-Result
Garry Spurr	28.0	39	W \$25	18	W \$20
J. Metcalf	12.0	38	r/u \$15, ntp	16	RU 2B
J. Little	33.0	34	B	15	
Simon Cossor	15.0	33	B	15	
Rhett Prescott	29.0	33	B	17	
D. Singleton	33.0	33	B	15	
D. Gray	24.0	23	ntp	8	



Craig and Bill McMillan playing the Sunday comp. where Bill played in the 9-hole comp while Craig went on and played the 18.

The "9-18" hole comp is a great opportunity for juniors to start getting involved in competition golf.

www.jinderaclub.com

Jindera Country Golf Club
Public group · 28 members

Follow us on Facebook or our website at www.jinderaclub.com.

VETS COMPETITION

Wednesday Mornings – 9 Holes

Name	Name	Name	Name	Net Score	Result
D. Rixon	F. Carmody	G. Miller	J. Wiesner	22.3	W
D. Castles	D. Singleton	B. Verbunt	D. Briggs	23.5	R/U

VETS Wed 11/05/2022 – Stableford – 15 players

Name	GA Hcap	Dly Hcp	Net Score	Result
D. Singleton			17	W
D. Webb			15	R/U
I. Dunn			15	B
D. Lord			14	B
J. Wiesner			14	B

VETS Wed 18/05/2022 - 3 Ball Ambrose - 15 Players

Name	Name	Name	Net Score	Results
D. Castles	J. Wiesner	I. Pertzelt	25	W
G. Witteveen	S. Millar	D. Webb	25	R/U

VETS Wed 25/05/2022 - Stableford – 16 Players

Name	GA Hcap	Dly Hcp	Net Score	Results
Doug (Visitor)			17	W
J. Wiesner			16	R/U
N. Winter			15	B
D. Castles			15	B
D. Singleton			14	B

CHOOK RUN

Chook Run - Fri 29/04/2022 – Stableford – 11 Players

Name	Dly Hcp	Net Score	Results
Rhett Prescott	28.0	19	W \$15
David Gray	25.0	16	R/U 3B
Tony Corrin	16.0	14	B
Strop Weldon	20.0	13	B
Craig McMillan	4.0	13	B
Nev Brand	15.0	10	B ntp

Chook Run - Fri 6/05/2022 – Stableford – 10 Players

Name	Dly Hcp	Net Score	Results
Bruce Hill	35.0	21	W \$10
Trev Freeman	20.0	17	R/U 2b
Tony Corrin	20.0	16	b
Strop Weldon	20.0	16	b
Rhett Prescott	19.0	15	b

Chook Run - Fri 13/05/2022 – Stableford – 9 Players

Name	GA Hcap	Dly Hcp	Net Score	Results
Graham Schilg	0	15.0	19	W \$10
Don Singleton	0	33.0	18	R/U 2b
Peter Penny	0	18.0	15	B
Rhett Prescott	0	19.0	13	B

Chook Run - Fri 20/05/2022 – Stableford – 7 Players

Name	Dly Hcp	Net Score	Results
P. Penney	18.0	16	W C/B \$10
Strop	25.0	16	R/U 2B
B. Hill	19.0	15	B
T. Duus	27.0	14	B
R. Prescott	19.0	9	NTP, B

LADIES - Thurs./Sun

Ladies 21 - Thurs 5/5 and Sun 8/5 – Stableford

Name	Dly Hcp	18 Score	18-Result	9 Score	9-Result
Thursday 5/5					
Elizabeth Heir	37	-	-	17	
Heather Chaston	35	-	-	17	
Sun 8/5					
Mihi Smith	45	36	W	-	
Lucy Kimpton	40	35	R/U	-	
Rawinia Smithenbecker	12	30		-	
Julie Hayes	27	26		-	

JINDERA ANGLERS CLUB INC.

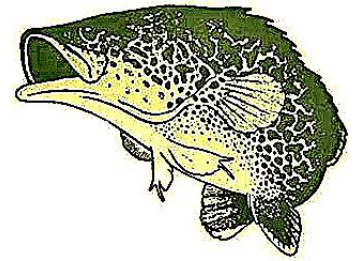

IMPORTANT DATE CHANGE

This month's general meeting will be held this Friday, 3rd June at 5.30pm at the clubhouse (due to the long weekend on the following week)

Please note, any changes to club constitution or rules need to be submitted in writing and publicly displayed by the end of this week and presented at this general meeting.

The May fishing comp held on the last weekend of May is done and dusted, with the contenders for fisherman of the year targeting their missing species of fish or trying to upsize on previous fish caught. Anglers tackled the upper Murray, Lake Mulwala, the Hume Weir and also the dam at the recreation reserve.

The winner for the May Comp for biggest fish, was Brian Shannon with a nice 60cm cod (c & r) and Sham also won the best bag with the cod and a great bag of redfin 3790, Laszlo and Ricko had a bag of redfin 1800, (all caught at Laz's secret spot), Squeaky caught a 350mm cod in the upper Murray.

Saturday was also a reminder to check your safety gear as maritime were out and about doing safety checks, they are very thorough. They were impressed that the Jindera Anglers Club conducted the checking of inflatable life jackets.

Going into winter members should take the time to check your boat/trailer for wear and tear and give them a good maintenance check.

Murray Cray season is here again from June 1st to the end of August and with the Murray River water level slightly up craying should be good, 5 nets per person and make sure all nets are labelled correctly and observe

the 2 legal size crays per person. The size limit is 100mm and maximum 120mm from the eyes to start of the tail. It can take from 6 to 7 years for crays to reach maturity, so fish respectfully.

The Brown family have been touring up north and while Kevin got a nice 58 cm barra, Ashton brought home the chocolates with a ripper 95 cm barra and Indi was last seen in the jaws of a monster crocodile.....lucky it was a concrete replica.

The Jindera Anglers Club is holding a giant raffle to be drawn on Presentation Day on July 10th.

- 1ST Prize: Diawa TD Black Frog 3-6kg fishing rod with a Tatula 100 overhead reel (Valued at \$550)
- 2nd Prize: 2 pair of ACE Sunglasses (Valued at \$450)
- 3rd Prize: Cod Pro Shop Fishing gear pack (Valued at \$300).

Tickets \$2 and are available from all members or at Fiona Browns Takeaway Shop

Next Comp will be an Open Comp commencing on Friday 24th June from 4pm with the weigh-in on Sunday 28th June at 4pm at the clubhouse.

SAVE THE DATE

Annual General Meeting will be held on Friday, 8th July from 5.30pm

SAVE ANOTHER DATE

Presentation Day will be held on **Sunday, 10th July**, commencing at **1pm**, the day will commence with a magnificent culinary indulgence (meal) with trophy presentation and a huge raffle to follow.

Tight lines and may all your snags come from nudge!



The magnificent Tatula reel that is matched with black frog rod that is 1st prize in club's raffle



3rd prize in the club raffle a Cod Pro Shop gear pack



Laszlo found the redfin at the weir



Ashton with his 95cm barra



A small redfin being released



BJ attempted to weigh-in this beautiful fish



Kevin Brown with a nice Barra caught recently up north



Graham and Chris cooking up a storm for members



Sham with his Lake Mulwala 60cm cod

Jindera



Trading Hours

Mon – Fri 7:30am-7:00pm

Sat & Sun 8:00am-7:00pm

Find us on  to see our great specials, new lines recipes and loads more!

JINDERA COMMUNITY DIRECTORY

Anglers Club	0409 537 452	Morgan Country Car Club.....	0448 004 706
Friends in Action	0438 262 480	Multi Purpose Stadium Committee.....	0429 960 616
Childrens Services	6026 3877	Netball Club.....	0407 186 073
Community Forum	6026 3544	Pony Club	6026 3484
Conway Printing.....	6026 3611	Pre School.....	6026 3468
CWA.....	0428 263 318	Recreation Reserve	0438 263 417
Football Club.....	0409 263 658	Red Cross	1800 733 276
Friends of Jindera Wet Lands.....	0407 180 730	Rural Care Link	6026 3001
Golf Club.....	0418 690 510	St Johns Lutheran School.....	6026 3220
Jindera Lutheran Church.....	0427 200 035	St Mary MacKillop College.....	6045 9422
Jindera Pioneer Museum	6026 3622	St Paul’s Anglican Church.....	6040 6457
Jindera Public School.....	6026 3280	Swimming Pool	6026 3900
Jindera Post Office.....	6026 3201	Tennis Club.....	0424 179 051

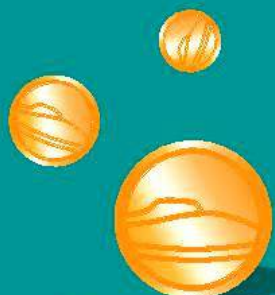

BuyLocal
in Greater Hume

Buy Local

Buying locally means local jobs and keeps our town alive.

Be Local - Think Local - Buy Local